

### Replacing the toner cartridge (TN-3145/TN-3185)

---

The TN-3185 toner cartridge can print approximately 7,000 pages using a high yield toner cartridge. When the toner cartridge is running low, the LCD shows **Toner Low**. The machine is supplied with a standard TN-3145 toner cartridge that must be replaced after approximately 3,500 pages. Actual page count will vary depending on your average type of document (i.e., standard letter, detailed graphics).



#### Note

---

It is a good idea to keep a new toner cartridge ready for use when you see the **Toner Low** warning.

---

Discard the used toner cartridge according to local regulations, keeping it separate from domestic waste. You can also check our ecology website [www.brothergreen.co.uk](http://www.brothergreen.co.uk) for recycling information. Be sure to seal up the toner cartridge tightly so that toner powder does not spill out of the cartridge. If you have questions, call your local waste disposal office.

We recommend that you clean the machine and corona wire of the drum unit when you replace the toner cartridge.

## Replacing the toner cartridge



### HOT SURFACE

After you have just used the machine, some internal parts of the machine will be extremely hot. When you open the front or back cover of the machine, **DO NOT** touch the shaded parts shown in the illustration.

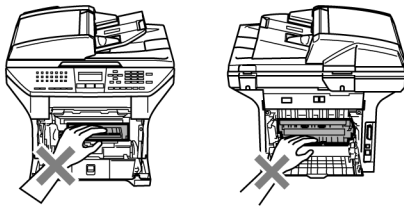

- 1 Open the front cover and take out the drum unit and toner cartridge assembly.

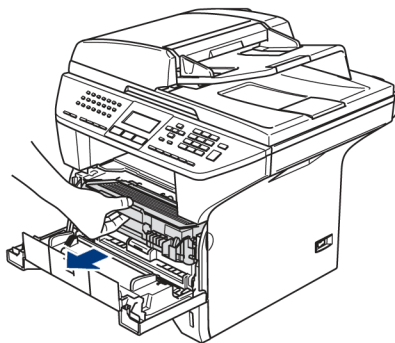

### CAUTION

To prevent damage to the machine from static electricity, **DO NOT** touch the electrodes shown in the illustration.

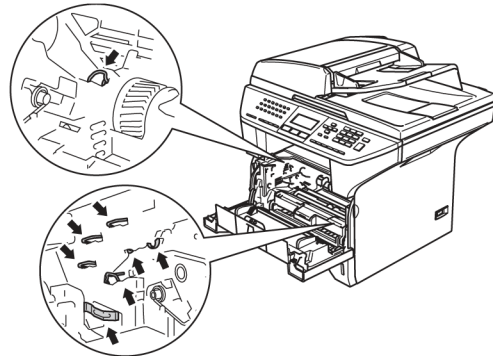

- 2 Hold down the lock lever on the right and take the toner cartridge out of the drum unit.

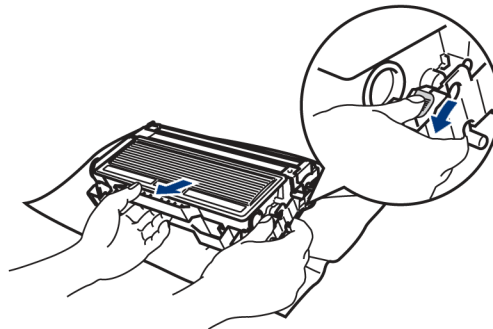

### WARNING

**DO NOT** put a toner cartridge into a fire. It could explode, resulting in injuries.

### ! CAUTION

Put the drum unit on a drop cloth or large piece of disposable paper to avoid spilling and scattering the toner.

Handle the toner cartridge carefully. If toner scatters on your hands or clothes, wipe or wash it off with cold water at once.

### ! CAUTION

Brother printers are designed to work with toner of a particular specification and work to a level of optimum performance when used with genuine Brother toner cartridges (TN-3145/TN-3185). Brother cannot guarantee this optimum performance if toner or toner cartridges of other specifications are used. Brother does not therefore recommend the use of cartridges other than Brother cartridges with this printer, or the refilling of empty cartridges with toner from other sources. If damage is caused to the drum unit or other part of this machine as a result of the use of toner or toner cartridges other than genuine Brother products due to the incompatibility or lack of suitability of those products with this machine, any repairs required as a result may not be covered by the warranty.

Unpack the toner cartridge just before you put it in the machine. If a toner cartridge is left unpacked for a long time, the toner life will be shortened.

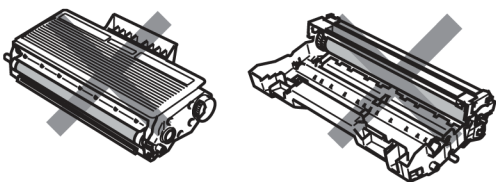

DO NOT touch the shaded parts shown in the illustrations to prevent any degradation to the print quality.

- 3 Unpack the new toner cartridge. Put the used toner cartridge into the aluminium bag and discard it according to local regulations.

- 4 Gently rock the toner cartridge from side to side five or six times to spread the toner evenly inside the cartridge.

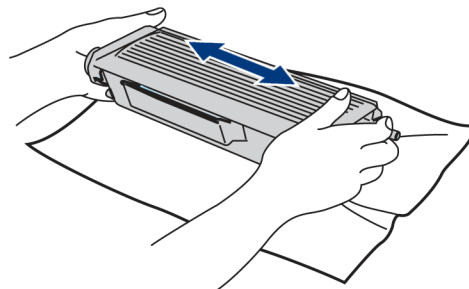

- 5 Pull off the protective cover.

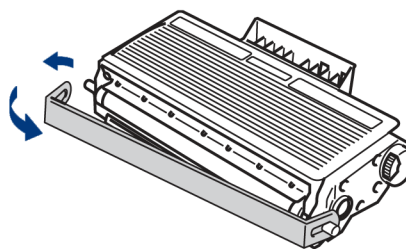

- 6 Put the new toner cartridge firmly into the drum unit until you hear it lock into place. If you put it in properly, the lock lever will lift automatically.

